



VILLAGE OF SILVERTON

COMMITTEE OF THE WHOLE

COUNCIL AGENDA

SILVERTON COUNCIL – ONLINE MEETING

April 29, 2020

4:00 pm

A. CALL TO ORDER

B. THE VILLAGE OF SILVERTON ACKNOWLEDGES THE INDIGENOUS PEOPLES ON WHOSE TRADITIONAL TERRITORIES WE STAND

C. ADDITION OF LATE ITEMS IF ANY

D. DELEGATION

None at this time.

E. DISCUSSION

E1. Lakeside Campground and next steps

E2. COVID 19 Impacts to campground

F. ADJOURNMENT

Boat launch

Leadville

4" water line.

asset management H₂O loop

c⁺ El

upper level.

Road.

WAY.

Road way.

Lake

power water

shed.

septic field.

Wash Rooms

Public Access TO Beach.

WATER STREET.

201

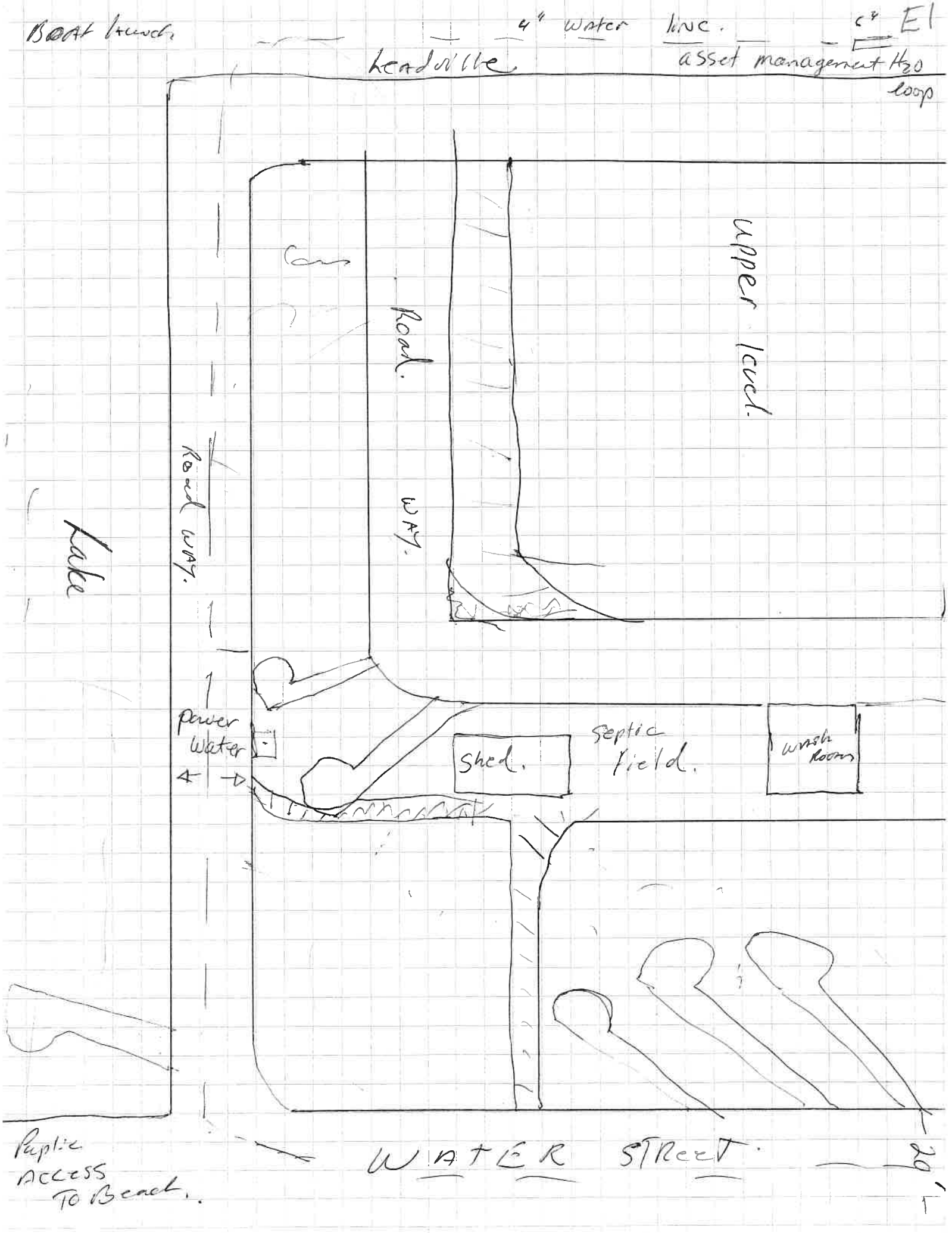

E1

helliott@silverton.ca

From: [REDACTED]
Sent: April 15, 2020 1:31 PM
To: hellriott@silverton.ca
Subject: 3 ft Douglas Fir trees for sale

Categories: Corporate resource

Hello,

We have 75 - 2-3ft Douglas Fir trees (they are from our Christmas tree farm) for sale. I wonder if the Village of Silverton is interested to buy them?
They are \$5 each or if you want all 75 of them we would work out a bulk price. Each tree is in a 3 gallon pot and can be planted at your convenience.
Please let me know if your village would be interested in buying these trees.

Sincerely,
Darlene [REDACTED]
250 [REDACTED]

 B.C. has declared a state of emergency. Learn about [COVID-19 health issues](#). | Get [COVID-19 Provincial Support](#).
British Columbia News

All BC Parks closing

<https://news.gov.bc.ca/21966>
Wednesday, April 8, 2020 8:00 AM

Victoria - BC Parks is immediately closing all provincial parks in response to the widespread call for increased action to address COVID-19.

The closure responds to both the federal and provincial directives that people should stay close to home to reduce COVID-19 transmission risk. This temporary measure means people should not be going to provincial parks until further notice.

“Because physical distancing works, it is critical that we take every action needed to restrict the spread of COVID-19. This applies to British Columbians and out-of-province visitors who were planning to visit or stay at our provincial parks. The message is clear: stay home, avoid travel, do not put yourself or others at risk,” said George Heyman, Minister of Environment and Climate Change Strategy.

“I understand and share the love people in British Columbia have for the outdoors and the connection between health and proximity to nature. We tried to provide safe space for people to get some exercise and fresh air in our beautiful parks. But it has proven too challenging to maintain safe distance between visitors. This action is difficult but necessary. We look forward to the day we can welcome people back to our wonderful parks.”

The decision to close the park system is informed by continued feedback from RCMP, local government, First Nations, local search-and-rescue organizations and the general public. While many people are observing the physical distancing requirements set by the provincial health officer (PHO), some continue to ignore the order, making enforcement in a wilderness setting challenging.

The timing of this decision is important given the upcoming long weekend and the beginning of the busy season for outdoor recreation and camping. BC Parks is also extending the ban on all camping in provincial parks until May 31, 2020, in alignment with neighbouring jurisdictions and the temporary closure of Canada’s national parks. Refunds for bookings up to May 31 will be sent automatically.

As previously announced, the Recreation Sites and Trails BC (RSTBC) branch of the Ministry of Forests, Lands, Natural Resource Operations and Rural Development has also closed its campgrounds and amenities in response to the COVID-19 situation.

BC Parks has taken a scaled and phased in approach to limiting park access following PHO requirements and the latest COVID-19 transmission data. BC Parks recognizes the value of nature in contributing to public health and wellness and will expand access to the park system as soon as the PHO indicates it can be done without increasing the risk of COVID-19 transmission.

Learn More:

Any change to provincial park access or services will be posted to the BC Parks website: <http://bcparks.ca>

For status updates on RSTBC campgrounds, visit:

<https://www2.gov.bc.ca/gov/content/sports-culture/recreation/camping-hiking/sites-trails>